

**NOTES**

- THIS DRAWING IS TO BE READ IN CONJUNCTION WITH ALL ENGINEERS & ARCHITECTS DRAWINGS FIGURED DIMENSIONS ONLY (NOT SCALING) TO BE USED. WHERE A CONFLICT OF INFORMATION EXISTS OR IF IN ANY DOUBT - ASK.
- CONSULTANTS TO BE INFORMED IMMEDIATELY OF ANY DISCREPANCIES BEFORE WORK PROCEEDS.

**CIVIL LEGEND**

- PERMEABLE PAVING TO ARCHITECT'S SPECIFICATION WITH HIGH LEVEL OVERFLOW TO SURFACE WATER NETWORK. REFER TO DETAIL IN DRAWING C1210
- BITUMINOUS CONCRETE ASPHALT ROAD SURFACE. REFER TO DETAIL A ON DRAWING C1210
- PAVING AS PER LANDSCAPE ARCHITECTS SPECIFICATION
- CONCRETE FOOTPATH TO DUBLIN CITY COUNCILS TAKING IN CHARGE STANDARDS. REFER TO DRG. C1210 FOR DETAILS
- CYCLE LANE AS PER LANDSCAPE ARCHITECTS LAYOUT
- TACTILE BLISTER PAVING (BUFF IN COLOUR). REFER TO DWG C1210 FOR DETAILS
- TACTILE BLISTER PAVING (RED). REFER TO DWG C1210 FOR DETAILS
- NEW IN-SITU CONCRETE KERB. REFER TO DETAIL B ON DRAWING C1210 FOR DETAILS
- DK DENOTES GROPPED KERB, I.E. 6-6mm UPSTAND. (NOTE KERBS TO FRONT OF PARKING/DRIVEWAYS SHALL BE LIMITED TO 25mm UPSTAND. STANDARD 125mm KERBS TO BE PROVIDED ELSEWHERE UNLESS OTHERWISE NOTED.)
- DENOTES PROPOSED TRAFFIC SIGN ON NEW 76.1mmØ CHS GALVANISED POST AND FOUNDATION
- SITE BOUNDARY
- SITE OWNERSHIP

**UNLES NOTED OTHERWISE REFER TO LANDSCAPE ARCHITECTS DRAWINGS FOR ALL SOFT LANDSCAPING, FOOTPATHS AND HARD LANDSCAPING TO COURTYARD AREAS**

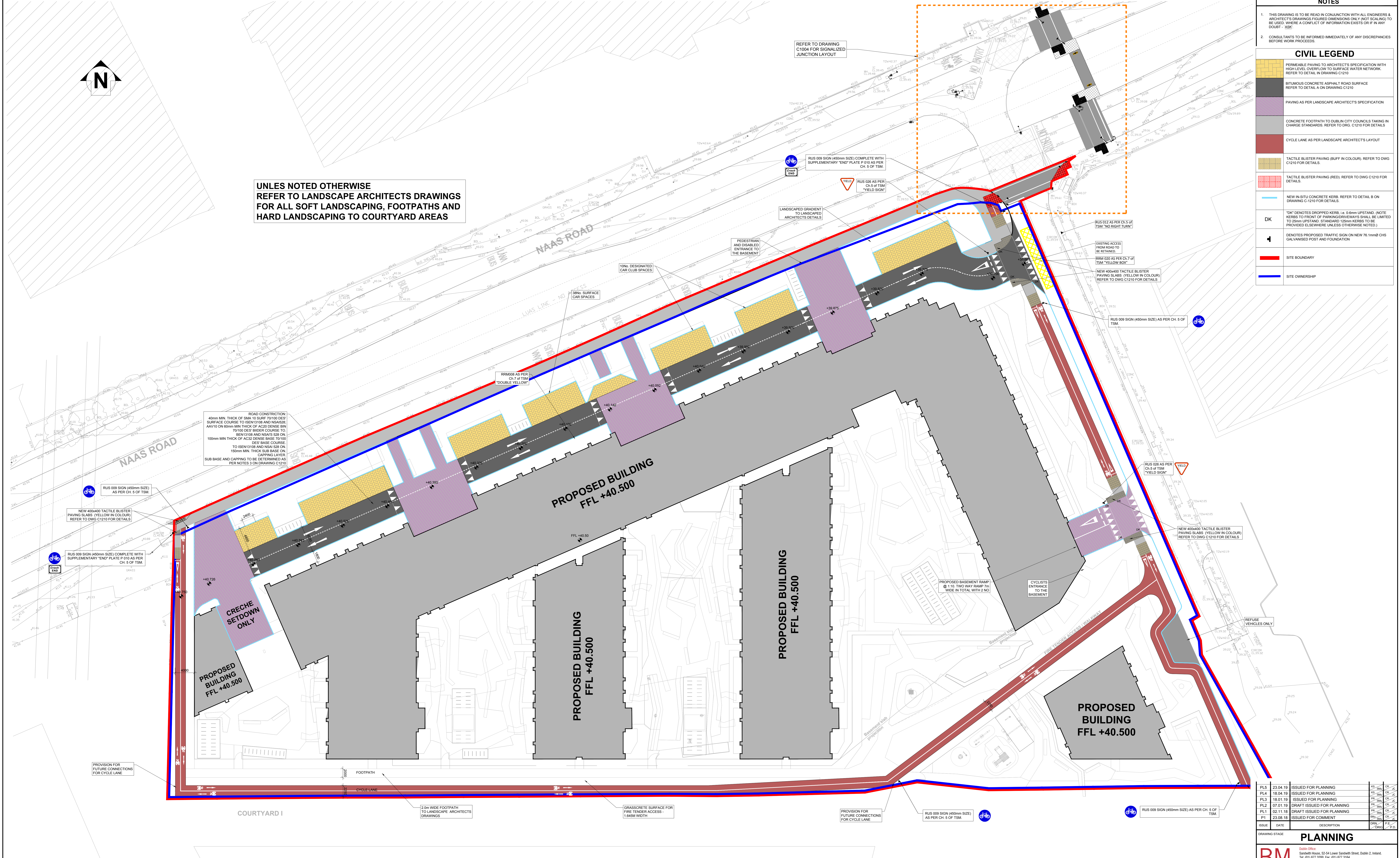

**PROPOSED ROADS & SURFACE LAYOUT**

SCALE @ A1: 1:250  
SCALE @ A2: 1:500

ISSUE	DATE	DESCRIPTION	DRG.	P.	S.
PLS	23.04.19	ISSUED FOR PLANNING	AS	01	01
PL4	18.04.19	ISSUED FOR PLANNING	AS	01	01
PL3	18.01.19	ISSUED FOR PLANNING	AS	01	01
PL2	07.01.19	DRAFT ISSUED FOR PLANNING	AS	01	01
PL1	02.11.18	DRAFT ISSUED FOR PLANNING	AS	01	01
P1	23.08.18	ISSUED FOR COMMENT	AS	01	01

**PLANNING**

**BM**  
DUBLIN OFFICE  
Sawthill House, 53-54 Lower Sawthill Street, Dublin 2, Ireland  
Tel: 01 472 2200 Fax: 01 472 2154  
LONDON OFFICE  
12 Mill Street, London SE1 2AQ, United Kingdom  
Tel: (0204) 084 5413 2722  
Consulting Engineers, Civil, Structural, Project Management E-mail: info@bm.ie Web: www.bm.ie

**Barrett Mundy**  
The Institution of Structural Engineers  
**ACEI**  
The Institution of Civil Engineers

CLIENT	DEVELOPMENT 8	DESIGN NUMBER	
PROJECT TITLE	CONCORDE RESIDENTIAL DEVELOPMENT	PROJECT NO.	18.232
MODEL REFERENCE	CCRD-BMD-00-ZZ-DR-C-1010	MODEL REV.	P1
DRAWING TITLE	PROPOSED ROADS & SURFACE LAYOUT	SUBMIT	S1

DRAWING NO: CCRD-BMD-00-ZZ-DR-C-1002  
PAGE: PL5